

**vtech**<sup>®</sup>  
Baby

User's Manual

# Toot-Toot Drivers<sup>®</sup>

## Parking Tower

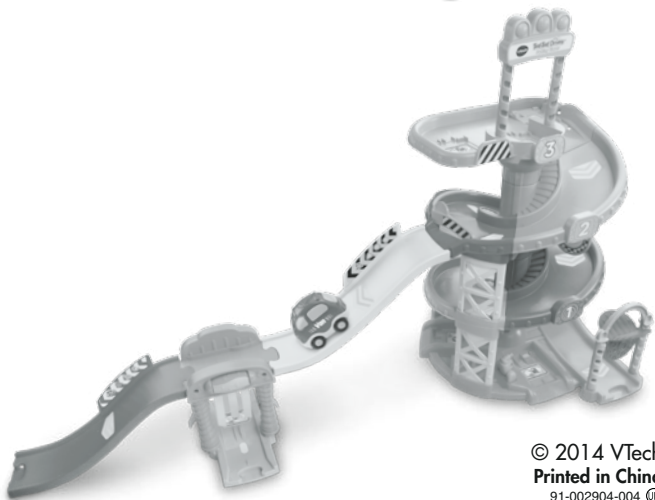

© 2014 VTech  
Printed in China  
91-002904-004 UK

**VTech understands that a child's needs and abilities change as they grow and with that in mind we develop our toys to teach and entertain at just the right level...**

## **vtech** Baby

**Toys that will stimulate their interest in different textures, sounds and colours**

### **I am...**

...responding to colours, sounds and textures

...understanding cause and effect

...learning to touch, reach, grasp, sit-up, crawl and toddle

*Birth-36 months*



## **Pre-School**

**Interactive toys to develop their imagination and encourage language development**

### **I want...**

...to get ready for school by starting to learn the alphabet and counting

...my learning to be as fun, easy and exciting as can be

...to show my creativity with drawing and music so my whole brain develops

*3-6 years*



## **Electronic Learning Computers**

**Cool, aspirational and inspiring computers for curriculum related learning**

### **I need...**

...challenging activities that can keep pace with my growing mind

...intelligent technology that adapts to my level of learning

...National Curriculum based content to support what I'm learning at school

*4-10 years*



To learn more about this and other VTech® products, visit [www.vtechuk.com](http://www.vtechuk.com)

# INTRODUCTION

Thank you for purchasing the **VTech® Toot-Toot Drivers® Parking Tower** learning toy!

Park, roll and play with the **VTech® Toot-Toot Drivers® Parking Tower!** Your child will develop fine motor skills as they park the included van, move it through the car wash and launch it down the speedy spiral. Six SmartPoint™ locations add to the fun by triggering fun vehicle responses (SmartPoint™ vehicles only).

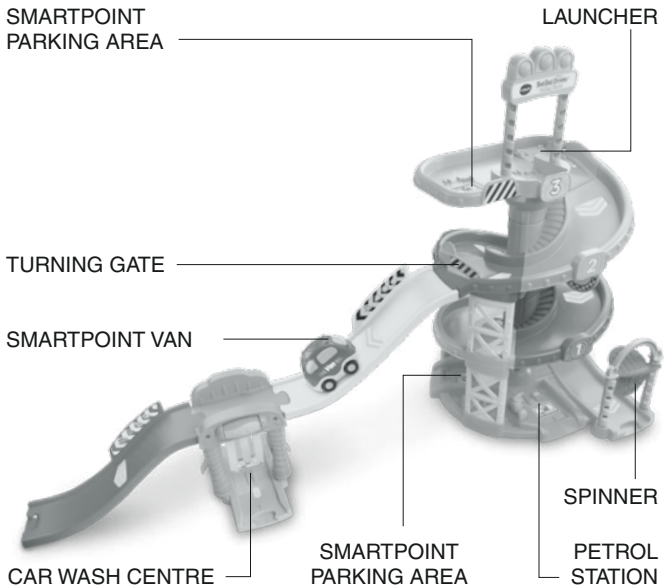

# INCLUDED IN THIS PACKAGE

- One user's manual



One SmartPoint™ Van



One tower base



One tower roof piece



Four spiral ramp pieces



One parking tower sign

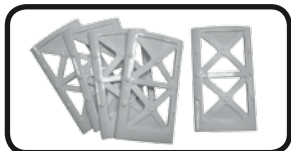

Five tower support pieces



One archway to assemble the spinner



One spinner



Two ramp track pieces



One car wash centre base track



One Car wash centre

## WARNING:

All packing materials, such as tape, plastic sheets, packaging locks and tags are not part of this toy, and should be discarded for your child's safety.

## NOTE:

Please keep this instruction manual as it contains important information.

# GETTING STARTED

## BATTERY INSTALLATION

1. Make sure the unit is turned **OFF**.
2. Locate the battery cover on the bottom of the van. Use a coin or a screwdriver to loosen the screw.
3. Install 2 new "AAA" (AM-4/LR03) batteries following the diagram inside the battery box. (The use of new alkaline batteries is recommended for maximum performance.)
4. Replace the battery cover and tighten the screw to secure.

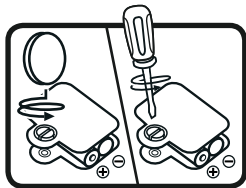

## BATTERY NOTICE

- Use new alkaline batteries for maximum performance.
- Use only batteries of the same or equivalent type as recommended.
- Do not mix different types of batteries: alkaline, standard (carbon-zinc) or rechargeable (Ni-Cd, Ni-MH), or new and used batteries.
- Do not use damaged batteries.
- Insert batteries with the correct polarity.
- Do not short-circuit the battery terminals.

- Remove exhausted batteries from the toy.
- Remove batteries during long periods of non-use.
- Do not dispose of batteries in fire.
- Do not charge non-rechargeable batteries.
- Remove rechargeable batteries from the toy before charging (if removable).
- Rechargeable batteries are only to be charged under adult supervision.

### Disposal of batteries and product



The crossed-out wheellie bin symbols on products and batteries, or on their respective packaging, indicates they must not be disposed of in domestic waste as they contain substances that can be damaging to the environment and human health.



The chemical symbols Hg, Cd or Pb, where marked, indicate that the battery contains more than the specified value of mercury (Hg), cadmium (Cd) or lead (Pb) set out in Battery Directive (2006/66/EC).

The solid bar indicates that the product was placed on the market after 13th August, 2005.

Help protect the environment by disposing of your product or batteries responsibly.

For more information, please visit:

[www.recycle-more.co.uk](http://www.recycle-more.co.uk)

[www.recyclenow.com](http://www.recyclenow.com)

# ASSEMBLY INSTRUCTIONS

With the VTech® Toot-Toot Drivers® Parking Tower, safety comes first. To ensure your child's safety, adult assembly is required.

## Assemble the parking tower:

1. Insert the support piece into the slot on the tower base with the number "1" engraving on the back; repeat the above step to fix the other two support pieces.
2. Insert the spiral ramp with the number "2" engraving on the back into the tower base, then fit the slots on the spiral ramp into the support pieces; repeat the above step to fit the spiral ramp with the number "3" engraving.
3. Insert the final two support pieces into the slots of the spiral ramp with the number "2" engraving.
4. Repeat the steps above to fix the spiral ramp with the number "4" engraving.

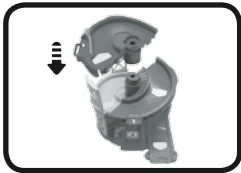
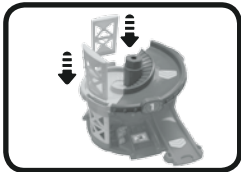
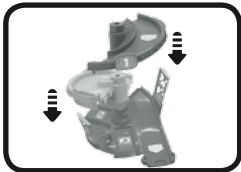
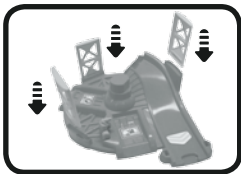

5. Insert the spiral ramp with the number “5” engraving on the back into the number “4” spiral ramp; repeat the above to fix the tower roof, labelled number “6” into place.



6. Insert the parking tower sign into the slots on the tower roof and attach the spinner to the archway, then insert the archway into the slot on the tower base.

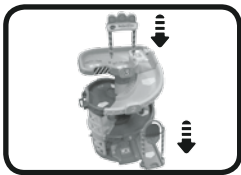

## Assemble the car wash centre:

7. Insert the car wash centre into the car wash centre base track. After that, connect the car wash centre and the car parking tower with the ramp track with the number “7” engraving, and attach the ramp track with the number “8” engraving to the car wash centre platform.

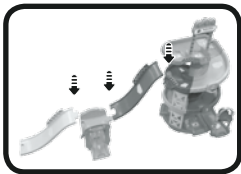
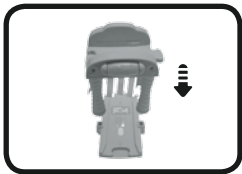



# VAN FEATURES

## 1. ON/OFF SWITCH

To turn the van **ON**, slide the **ON/OFF SWITCH** on the van to the **ON** (☰) position. To turn the van **OFF**, slide the **ON/OFF SWITCH** to the **OFF** (●) position.

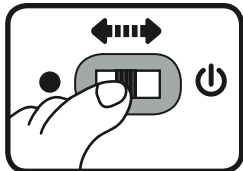

## 2. AUTOMATIC SHUT-OFF

To preserve battery life, the van included with the **VTech® Toot-Toot Drivers® Parking Tower** will automatically power-down after approximately 60 seconds without input. The unit can be turned on again by pressing the light-up driver button or pushing the van quickly.

**Note:** This product is in a try-me mode in the packaging. After opening the package, turn the vehicle off and on again to proceed with normal play.

# VAN ACTIVITIES

1. Slide the **ON/OFF SWITCH** to turn the van **ON**. You will hear van sounds, a song and a phrase. The light will flash with the sounds.

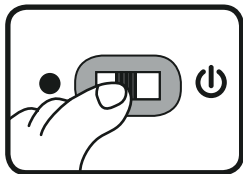

2. Press the **LIGHT-UP BUTTON** to hear van sounds, songs and phrases. The light will flash with the sounds.
3. Push the van to hear the sounds and melodies. While a melody is playing, push the van again to add in fun sounds on top of the melody. The light will flash with the sounds.
4. For added fun, the van interacts with the **VTech® Toot-Toot Drivers® Parking Tower**. Simply roll the van over one of the parking tower's six **SmartPoints** to see the van's light flash and to hear greetings, fun sounds, short tunes and sing-along songs. The van even interacts with other **Toot-Toot Drivers®** play sets (each play set sold separately).

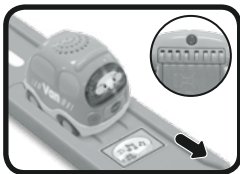

## PARKING TOWER ACTIVITIES

1. To launch the van down the spiral, place the van on the **LAUNCHER** at the top of the parking tower. Lift up the **LAUNCHER** to see the van roll down.



2. Switch the gate position to choose a different route.

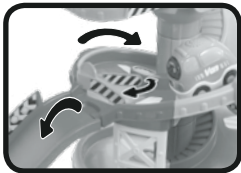

3. Put the included **Toot-Toot Drivers® SmartPoint™ Van** on one of the play set's six SmartPoint locations to hear fun phrases and sounds. (**SmartPoint™** vehicles only. Other vehicles sold separately.)



4. Move the van through the **CAR WASH** as you pretend to get your vehicle sparkly clean.



5. Drive your vehicle in to the **Petrol station** for a fill-up.



## MELODY LIST

1. The old Grey Mare
2. She'll be Coming Round the Mountain
3. Shoo fly, don't bother me
4. This Old Man
5. Yankee Doodle
6. Bicycle Built for Two

## SING-ALONG SONG LIST

### Sing-Along Song 1

Come on my friends, buckle up tight!  
Room for my friends, happy as we go!  
Beep-beep,  
Zoom around the town!

### Sing-Along Song 2

I'm a van, a little van, I love driving round!

### Sing-Along Song 3

I can carry lots of things in my van, go for a drive with me.

## CARE & MAINTENANCE

1. Keep the unit clean by wiping it with a slightly damp cloth.
2. Keep the unit out of direct sunlight and away from any direct heat source.
3. Remove the batteries when the unit will not be in use for an extended period of time.
4. Do not drop the unit on hard surfaces and do not expose the unit to moisture or water.

# TROUBLESHOOTING

If for some reason the program/activity stops working or malfunctions, please follow these steps:

1. Please turn the unit **OFF**.
2. Interrupt the power supply by removing the batteries.
3. Let the unit stand for a few minutes, then replace the batteries.
4. Turn the unit **ON**. The unit should now be ready to play again.
5. If the product still does not work, replace with a new set of batteries.

If the problem persists, please call our Consumer Services Department on 01235 546810 (from UK) or +44 1235 546810 (outside UK) and a service representative will be happy to help you.

## IMPORTANT NOTE:

Creating and developing **VTech®** products is accompanied by a responsibility that we take very seriously. We make every effort to ensure the accuracy of the information, which forms the value of our products. However, errors sometimes can occur. It is important for you to know that we stand behind our products and encourage you to call our Consumer Services Department on 01235 546810 (from UK) or +44 1235 546810 (outside UK), with any problems and/or suggestions that you might have. A service representative will be happy to help you.



CLASS 1  
LED PRODUCT



## PRODUCT WARRANTY



Thank you for choosing this quality product from VTech. We hope it will bring many hours of entertainment, imaginative play and learning.

1. The product detailed above is covered by a one year warranty from the date of purchase, against any defects in materials or workmanship.
2. The product may be returned to the place of purchase. Alternatively the product can be returned to VTech Electronics Europe plc (see address below), with proof of purchase, without proof of purchase no replacement will be provided.
3. VTech Electronics Europe plc will examine the product and if it is found to be defective due to faulty materials or workmanship, will replace the product at their discretion.
4. If the product covered by this warranty is damaged due to misuse, modification or unauthorised repair, or because of faulty batteries, battery discharge or incorrect electrical connections, then this warranty becomes void.
5. This warranty is personal to the original purchaser and is not transferable.
6. Breakages to the LCD screen are not covered by the warranty.
7. Returns to VTech Electronics Europe plc should include a cheque or postal order for £1.50 towards the cost of return postage and packaging.
8. Products returned to VTech Electronics Europe plc, should be addressed as follows and packed carefully to avoid damage in transit (Please do not include batteries or adaptor).  
Please include details of the fault together with your name and address.

VTech Electronics Europe plc, c/o Tablogix Limited, 200 Milton Park, Abingdon, Oxon OX14 4TA

**THIS WARRANTY IS OFFERED AS AN EXTRA BENEFIT AND DOES NOT AFFECT CONSUMERS' STATUTORY RIGHTS.**

This warranty is valid for the UK and Eire only. For products purchased outside the UK and Eire, please contact your local distributor or place of purchase.

